



**Interal T.C. bv**

**36 / 50**  
**PROTRUSS CATALOG**

## Protruss 36.

The P36 was specially developed for heavy duty applications - for stage applications, stand construction and rentals. In spite of the compact form of the truss, it can be used for building constructions spanning up to 20 m with a high loading factor. The P 36 truss is available in two versions: rectangular and square. Due to its slender shape, the rectangular model is also much in demand for applications in which the visual image generated plays an important role. The rectangular truss is also ideal from a logistics viewpoint (for storage as well as transport).

### technical specifications protruss

Type	R = Rectangle S = Square	
Alloy	51 st. AlMgSi 1 F 31 ISO Standard AlMgSi EN-AW 6082 T6	
Tube	Ø 50 x 4 mm	
Brace	Ø 25 x 3 mm	
Connection	Alu. connection piece with spigot and R-spring	

The conical connection pieces (large size) allow quick and easy assembly, practically without the use of tools. Interal produces a large assortment of corners, arches, circles and special constructions based on the Protruss 36 series.

The conical connection piece allows you to assemble your system in the shortest of time.

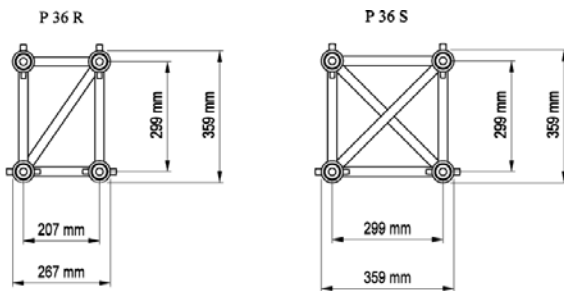

P 36 R

P 36 S

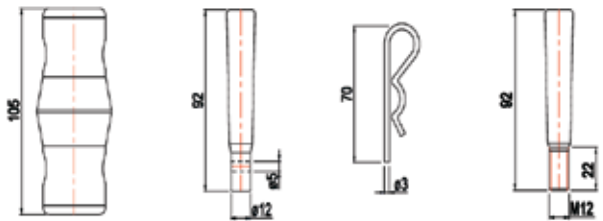

605011

605012

605013

605015



P 36 R

P 36 S



description

connection pieces

### PROTRUSS 36 SERIES

### TUBE - Ø 50 X 4

Standard Lengths (m)	0,50	0,60	0,80	1,00	1,20	1,50	1,60	2,00	2,40	2,50	3,00	3,20	3,50	4,00
36R (kg)	8,1	8,5	10,1	11,7	13,4	15,8	16,6	19,8	23,0	23,8	27,9	29,5	31,9	35,9
36S (kg)	8,9	9,8	11,0	12,9	14,8	16,2	18,5	22,2	25,4	26,8	31,5	33,3	36,1	40,7

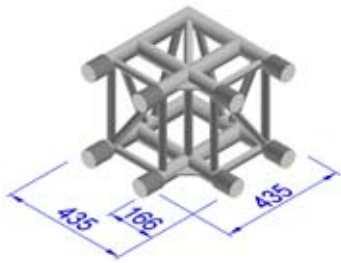

type	description
003	2 way corner 90° horizontal

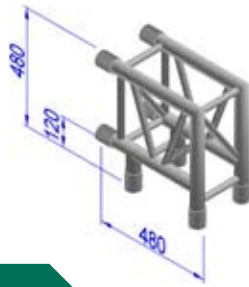

type	description
007	2 way corner 90° vertical

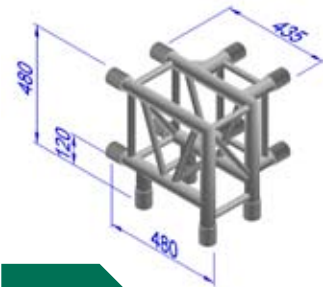

type	description
012	3 way corner 90° left



type	description
013	3 way corner 90° right

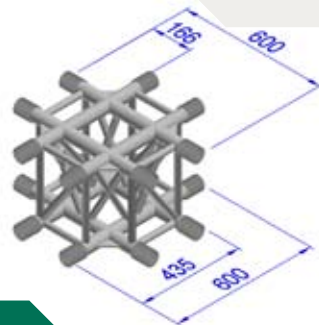

type	description
016	Cross

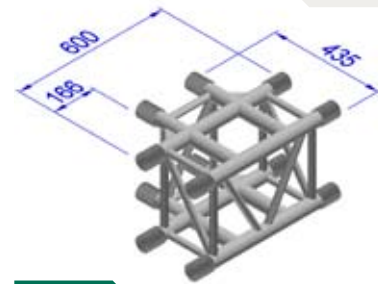

type	description
017	T-joint



type	description
363601	Boxcorner



type	description
603603	Mounting rack

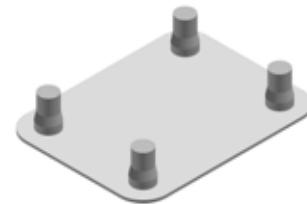

type	description
030	Base / wall plate 6 mm
031	Base / wall plate 8 mm



# CORNERS P36S

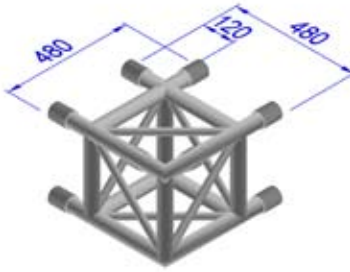

type	description
003	2 way corner 90°

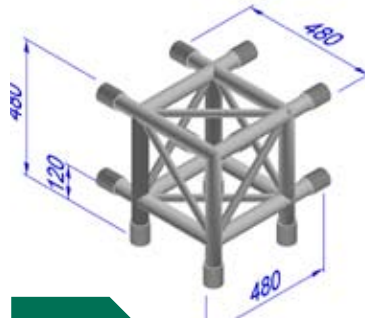

type	description
012	3 way corner 90°

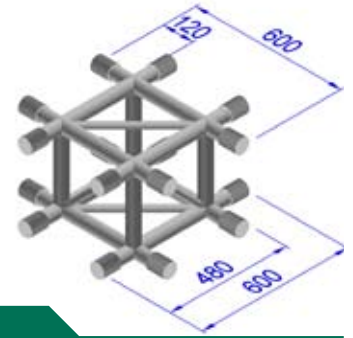

type	description
016	Cross

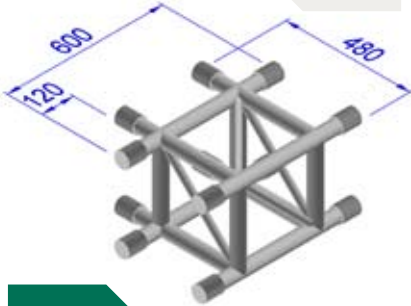

type	description
017	T-joint

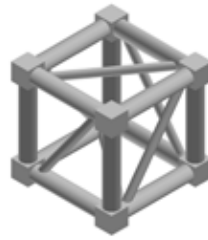

type	description
603602	Boxcorner



type	description
603604	Mounting rack

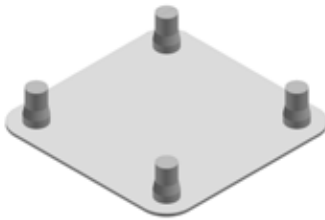

type	description
030	Base / wall plate 6 mm
031	Base / wall plate 8 mm

# CORNERS P50

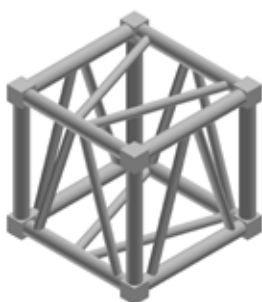

type	description
605001	Boxcorner

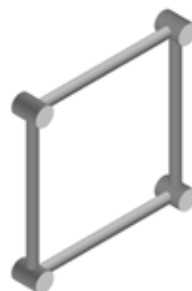

type	description
605003	Mounting rack

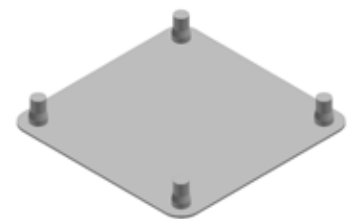

type	description
030	Base / wall plate 6 mm
031	Base / wall plate 8 mm

## Protruss 50.

The P50 was specially developed for extra heavy duty applications - for stage applications and for rentals. It can be used for building constructions with spans of up to 24 m and very high loading factors.

The P50 truss is available in two different models. The P50SV has braces on all four sides; the P50 SL truss has braces on two sides and ladder bars on the other two sides.

### technical specifications protruss

Type	50 SL 50 SV	
Alloy	51 st. AlMgSi 1 F 31 ISO Standard AlMgSi EN-AW 6082 T6	
Tube	Ø 50 x 4 mm	
Brace	Ø 30 x 3 mm	
Connection	Alu. connection piece with spigot and R-spring	

The conical connection pieces (large size) allow quick and easy assembly, practically without the use of tools. Internal produces a large assortment of corners, arches, circles and special constructions based on the Protruss 50 series.

The conical connection piece allows you to assemble your system in the shortest of time.

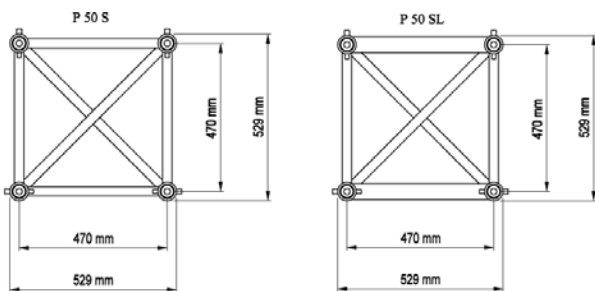

P 50 SV

P 50 SL



P 50 SV

P 50 SL

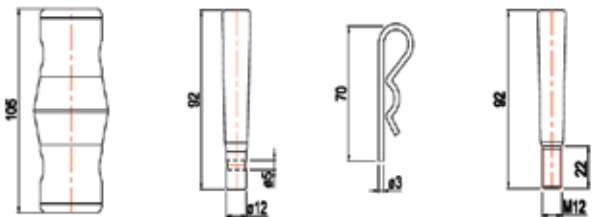

605011

605012

605013

605015



description

connection pieces

### PROTRUSS 50 SERIES

TUBE - Ø 50 X 4

Standard Lengths (m)	0,50	0,60	0,80	1,00	1,20	1,50	1,60	2,00	2,40	2,50	3,00	3,20	3,50	4,00
50SV (kg)	9,4	10,5	12,8	15,1	17,4	20,8	21,9	26,5	31,1	32,2	37,9	40,2	43,6	49,3
50SL (kg)	9,6	10,8	13,1	15,5	17,9	21,4	22,6	27,4	32,1	33,3	39,2	41,6	45,1	51,0

## PROTRUSS P36R

Length (M)	2	3	4	5	6	7	8	9	10
Point Load (Kg)	1737	1679	1719	1485	1469	1129	1257	904	893
3 Point Load (Kg at $\frac{1}{4}$ , $\frac{1}{2}$ and $\frac{3}{4}$ )	580	579	573	567	567	557	561	486	458
Uniformly Distributed load (Kg/M)	870	576	430	343	283	242	210	186	166
Uniformly Distributed Load (Kg)	1739	1729	1721	1711	1701	1691	1683	1673	1664

## PROTRUSS P36S

Length (M)	2	3	4	5	6	7	8	9	10
Point Load (Kg)	1767	1697	1732	1492	1474	1133	1238	905	892
3 Point Load (Kg at $\frac{1}{4}$ , $\frac{1}{2}$ and $\frac{3}{4}$ )	589	585	578	571	571	560	563	486	458
Uniformly Distributed load (Kg/M)	884	583	434	346	285	244	211	187	167
Uniformly Distributed Load (Kg)	1769	1749	1738	1726	1714	1702	1690	1679	1668

## PROTRUSS P50SV

Length (M)	2	3	4	5	6	7	8	9	10
Point Load (Kg)	3223	3274	2438	1866	1513	1489	1462	1468	1211
3 Point Load (Kg at $\frac{1}{4}$ , $\frac{1}{2}$ and $\frac{3}{4}$ )	1126	1073	814	1162	954	824	825	795	671
Uniformly Distributed load (Kg/M)	2623	866	654	634	475	414	363	307	253
Uniformly Distributed Load (Kg)	2623	2599	2616	3172	2849	2900	2901	2757	2528

## PROTRUSS P50SL

Length (M)	2	3	4	5	6	7	8	9	10
Point Load (Kg)	3158	3235	2431	1862	1533	1491	1459	1468	1210
3 Point Load (Kg at $\frac{1}{4}$ , $\frac{1}{2}$ and $\frac{3}{4}$ )	1103	1061	1042	1153	966	806	738	798	670
Uniformly Distributed load (Kg/M)	1284	856	646	626	469	416	365	306	254
Uniformly Distributed Load (Kg)	2569	2570	2586	3127	2815	2910	2915	2749	2536

The loading figures are valid only for application of the truss under static loading. The figures have been determined in accordance with DIN standards 4113 Part 1 and Part 2. Whenever dynamic loads are expected, the loading figures should be reduced by 50% ( we recommend to perform a recalculation ). For other loading conditions a structural engineer or Internal T.C. should be consulted.

The principle when using weight tables is that a load which is hung from the truss must be attached (by means of a clamp, sling, etc.) as close as possible to an intersection of the diagonals, so that the load is divided between (at least two) main tubes as much as possible.

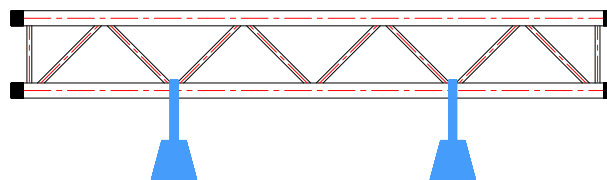

											TUBE - Ø 50 X 4			
11	12	13	14	15	16	17	18	19	20	21	22	23	24	
746	798	629	619	537	561	464	453	397	341					
402	396	333	319	284	263	225	194	168	144					
148	124	105	90	77	62	51	41	34	28					
1622	1496	1360	1255	1158	999	858	740	637	547					

											TUBE - Ø 50 X 4			
11	12	13	14	15	16	17	18	19	20	21	22	23	24	
744	782	626	614	531	544	456	443	381	325					
401	388	330	316	280	258	219	188	161	138					
147	147	104	89	76	61	49	40	33	27					
1618	1491	1346	1234	1143	979	837	716	612	522					

											TUBE - Ø 50 X 4			
11	12	13	14	15	16	17	18	19	20	21	22	23	24	
1052	917	902	882	878	768	691	622	608	591	575	524	478	435	
598	477	473	468	444	414	384	345	329	308	291	266	251	229	
213	185	156	134	116	100	88	78	68	60	54	48	43	39	
2347	2213	2031	1871	1742	1604	1497	1408	1298	1207	1130	1054	987	929	

											TUBE - Ø 50 X 4			
11	12	13	14	15	16	17	18	19	20	21	22	23	24	
1048	926	903	881	878	768	688	626	609	589	574	523	474	437	
593	479	465	467	445	413	379	346	329	306	291	266	248	228	
214	185	156	134	116	100	88	78	68	60	54	48	43	39	
2351	2216	2031	1865	1742	1604	1490	1406	1296	1201	1130	1052	978	928	



NO PART OF THIS CATALOG, INCLUDING THE PRODUCTS DESCRIBED IN IT, MAY BE REPRODUCED, TRANSMITTED, TRANSCRIBED, STORED IN A RETRIEVAL SYSTEM, OR TRANSLATED INTO ANY LANGUAGE FORM OR BY ANY MEANS, WITHOUT THE EXPRESS WRITTEN PERMISSION OF INTERAL T.C. BV.

SPECIFICATIONS AND INFORMATION CONTAINED IN THIS CATALOG ARE FURNISHED FOR INFORMATIONAL USE ONLY, AND ARE SUBJECT TO CHANGE AT ANY TIME WITHOUT NOTICE, AND SHOULD NOT BE CONSTRUED AS A COMMITMENT BY INTERAL T.C. BV.

INTERAL T.C. BV ASSUMES NO RESPONSIBILITY OR LIABILITY FOR ANY ERRORS OR INACCURACIES THAT MAY APPEAR IN THIS CATALOG, INCLUDING THE PRODUCTS DESCRIBED IN IT.



# Interal T.C. bv

Maasheseweg 73  
NL 5804 AB  
Venray  
Netherlands

t. +31 (0)478 542 018  
f. +31 (0)478 542 109  
e. [info@interal.nl](mailto:info@interal.nl)  
w. [www.interal.nl](http://www.interal.nl)

